

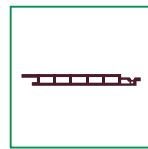

INSTALLATION GUIDE

Biowood Outdoor Wall Panel BWWPO20018 Shiplap 8x6 Deep



Congratulations on the fine choice you have made in the selection of this Biowood product. Biowood outdoor wall panels will give you many years of carefree maintenance. When installed in areas exposed to UV light, it must be coated with Intergrain Ultradeck Biowood coating to prevent colour fading. Biowood is very stable, it will not move in thickness and with. Unlike timber, it will move marginally in length.

How to install Biowood Outdoor Wall Panels

You will need:

- > Measuring Tape
- > Power Drop Saw or Fine Tooth Hand Saw
- > Cordless Screw Driver
- > Phillips Driver Bits
- > Caulking Gun
- > Pencil
- > Square
- > String Line
- > Paint Brush
- > 10mm Plug Cutter
- > Staple Gun
- > 25x12x1.6 Aluminium Angle
- > Selleys Liquid Nails Direct Stick
- > Sand Paper 120g
- > Intergrain Ultradeck
- > Stainless Steel Wood Screws C/s Head
32x6g, 19x6g, 16x6g
- > Stainless Steel Wood Screws Pan Head 19x8g
- > 6mm PVC Cap Mould
- > 10mm Staples
- > Surface Temperature Gauge
- > 5mm Drill Bit
- > S45O04232 (For External Corners)

Setting Out

These boards can be laid horizontal, vertical or diagonally. This profile is a shiplap profile with a 200mm cover and a 8mm wide x 6mm deep groove at joints. All boards are to be screwed and glued to the structural elements so as to achieve a bonded fixing method at spacings of not more than 450mm.

If installed onto battens, ensure that the battens are securely fastened and true to line to within a plus or minus tolerance of 3mm in 2m for both horizontal and vertical planes. All timbers are to be seasoned.



INSTALLATION GUIDE

Biowood Outdoor Wall Panel BWWPO20018 Shiplap 8x6 Deep

Board Set Out - Horizontal laid boards

- Start laying boards from the base of the wall.
- Install a 6mm PVC cap mould as starter strips at base of wall to support and lock the first board in place.
- Fix the starter strip with 10mm long staples fixed at 120mm frequency, a minimum of 5mm from the edge and to a straight line.
- Position the base of the starter strip 11mm above the bottom of the first board. (See Diagram 1/20018)
- Cut the first board and the remainder of the boards to be fixed to this wall to desired length. The temperature of the boards should be about 18°C when cutting to length. It is most important that all boards to be cut to length and installed in one wall be at the same temperature when cut. If this is not observed, the boards may expand and contract at different rates resulting in uneven board lengths. Leave a 5mm gap at the end of each board.
- Apply 3 beads of Selleys Liquid Nails Direct Stick to the face of every stud for the full length of the board.
- Lay the first board with groove facing down and insert the inner leg into the starter strip.
- Fix the tongue in the countersunk groove with 2 x 32mm x 6g Stainless Steel screws through a 3mm pilot hole. Position the screws 10mm in from the stud edge. Do not over tighten the screws. Best results are between .5 and 1mm of adhesive bed is achieved.
- Repeat this process for the remainder of the wall.

DIAGRAM 1 / 20018. Biowood WPO20018 laid horizontal - Starter strip detail. Bonded fixing method. Vertical section.

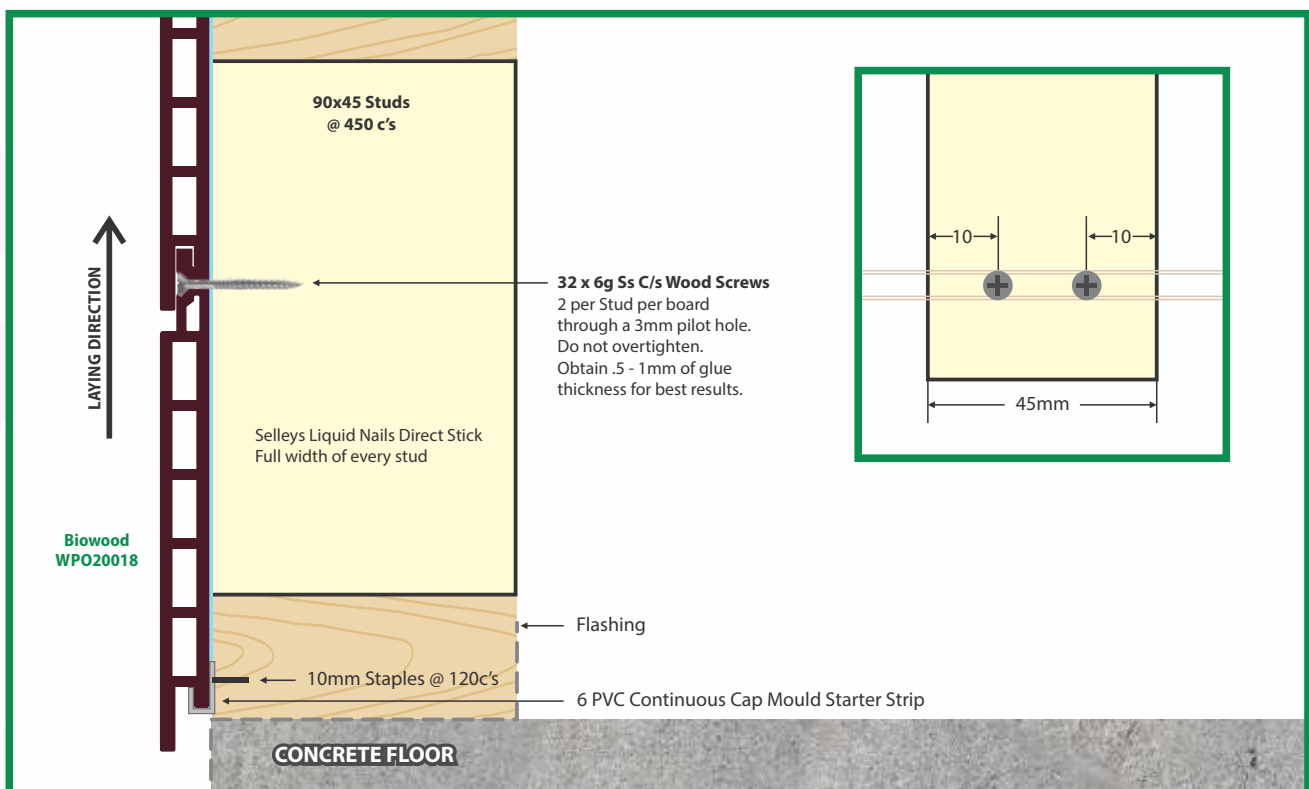



INSTALLATION GUIDE

Biowood Outdoor Wall Panel BWPO20018 Shiplap 8x6 Deep

External Corner - Horizontal Laid Boards

- Diagram 2/20018 shows the recommended method of creating an external corner for horizontal laid boards.
- Install the 25x12x1.6 aluminium angle first as set out in diagram 2/20018.
- Secure the Biowood S45004232 faces.
- Caulk the 5mm gaps with backer rod and coloured sikaflex or similar jointing compound.

DIAGRAM 2 / 20018. Horizontal Section - External Corner Detail for WPO20018 for Horizontal laid boards. Bonded fixing method

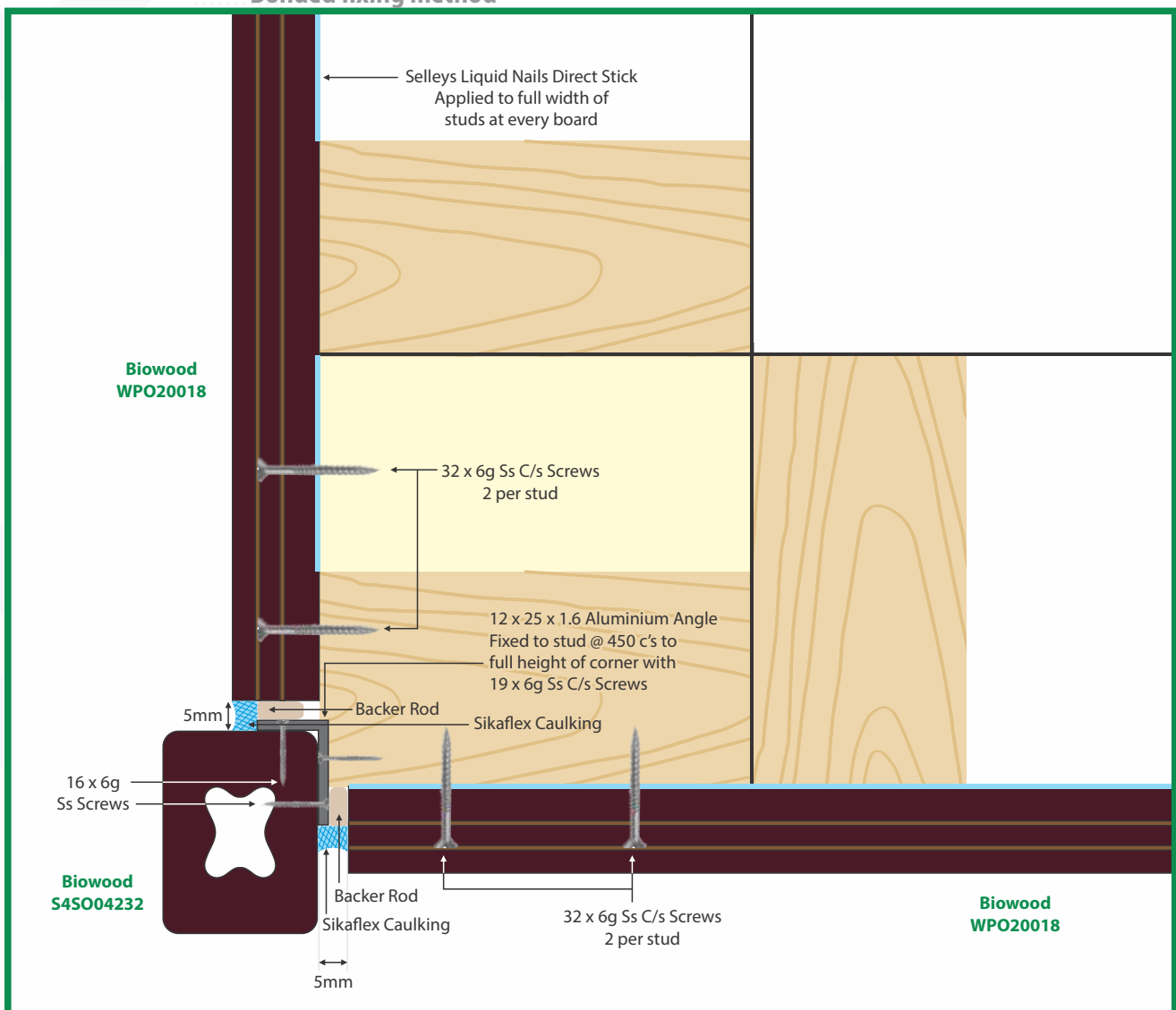



INSTALLATION GUIDE

Biowood Outdoor Wall Panel BWWPO20018 Shiplap 8x6 Deep

DIAGRAM 3 / 20018. External Corner Detail for WPO20018 for Vertical laid boards.
Bonded fixing method

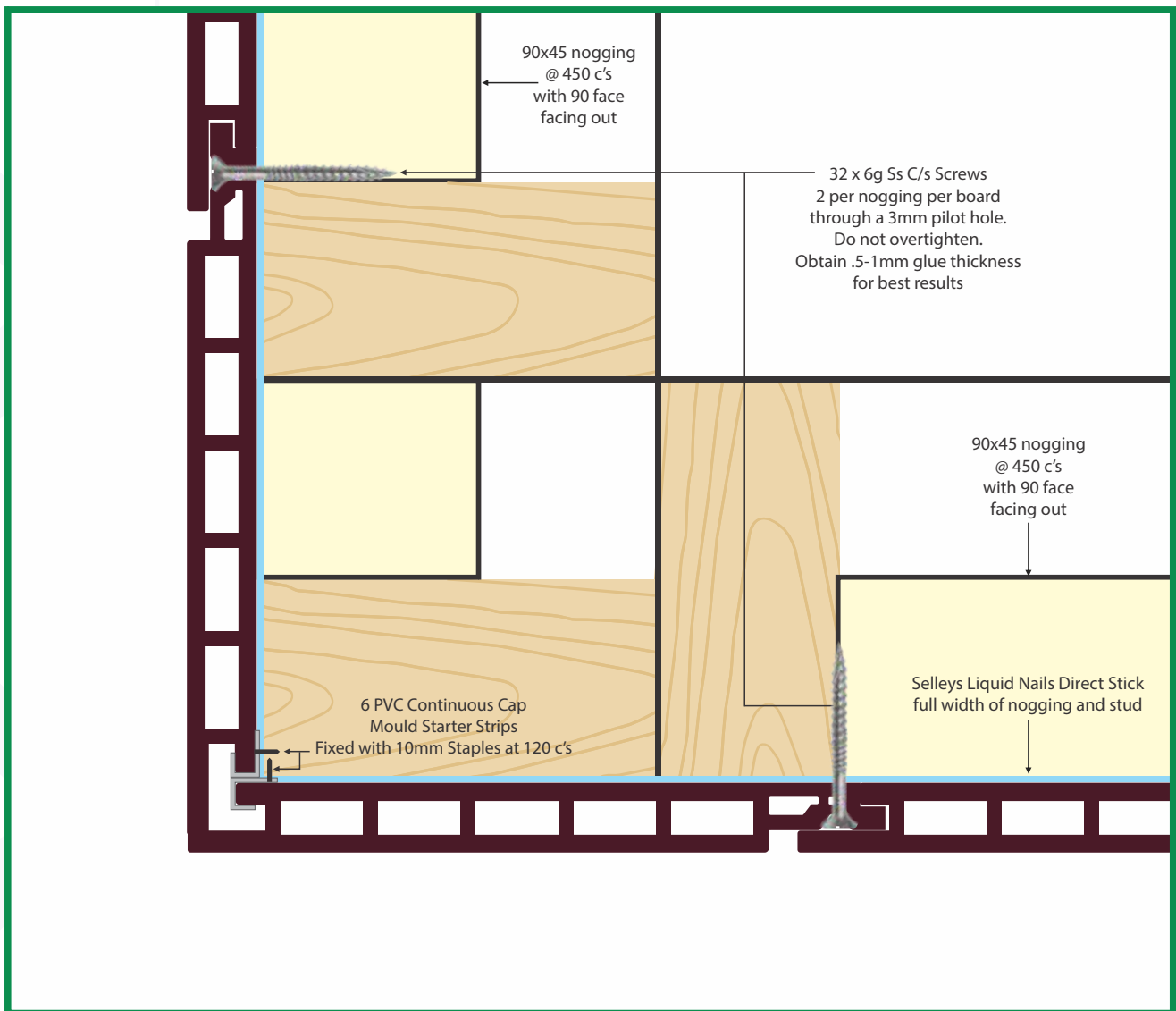



INSTALLATION GUIDE

Biowood Outdoor Wall Panel BWPO20018 Shiplap 8x6 Deep

Window Surround - Horizontal laid boards

- Most windows and doors surrounds can be lined with Biowood WP16016. This is a solid section 160x16mm smooth on all faces.
 - For reveals that are wider than 160, the Biowood WP16016 can be joined by fixing together with PVC solvent cement.
 - Use 32 x 6g Ss C/s screws to fix reveal to treated pine grounds and plug screws with Biowood plugs.
- See Diagram 4 / 20018.

DIAGRAM 4 / 20018. Window Surround - Detail Typical

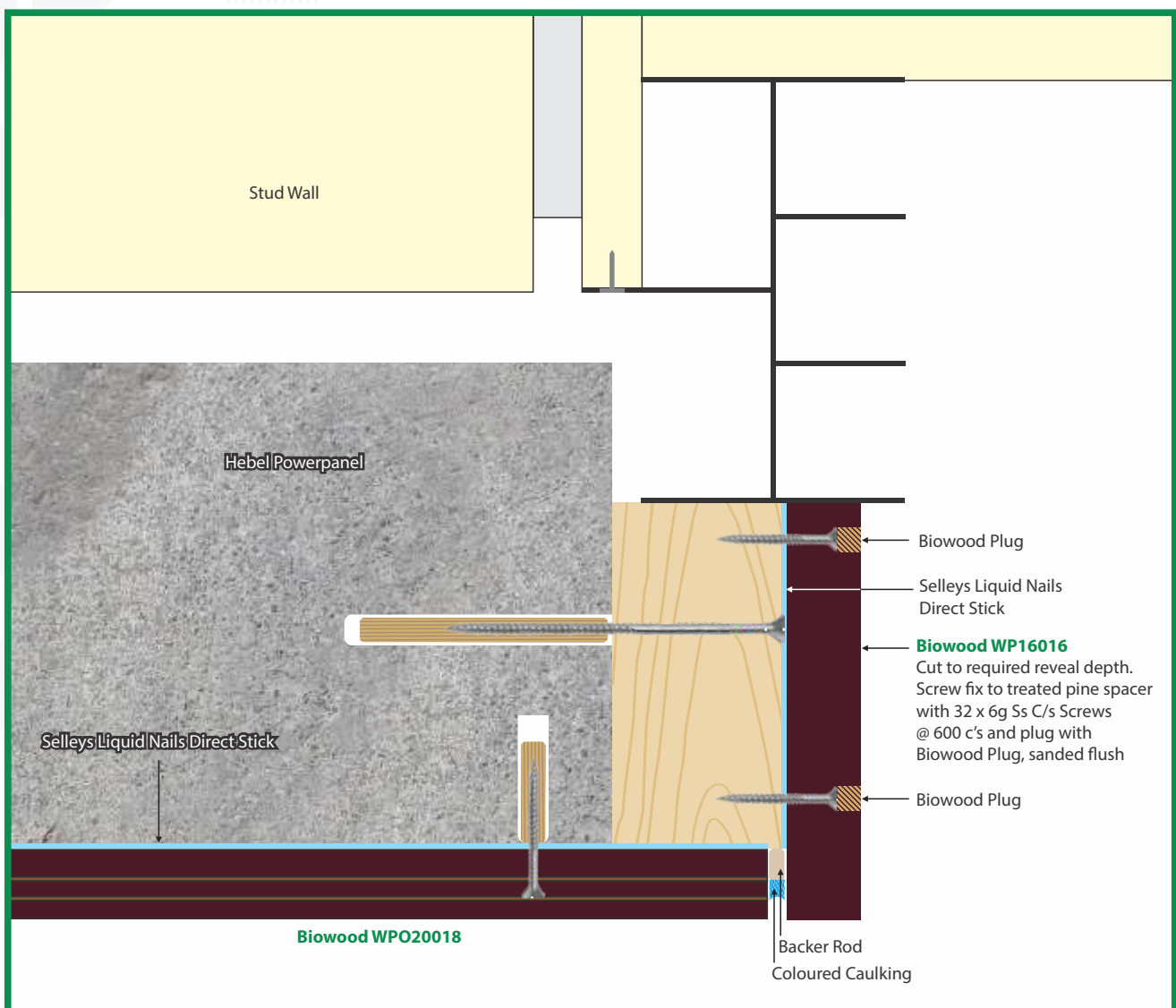



INSTALLATION GUIDE

Biowood Outdoor Wall Panel BWPO20018 Shiplap 8x6 Deep

Internal Corner - Horizontal laid boards

- A simple butt joint is recommended for an internal corner.
- Leave a 5mm gap at the end of each board.
- Caulk the vertical expansion gap with coloured caulking compound over backer rod. See Diagram 5 / 20018.

DIAGRAM 5 / 20018. Horizontal Laid Biowood WPO20018

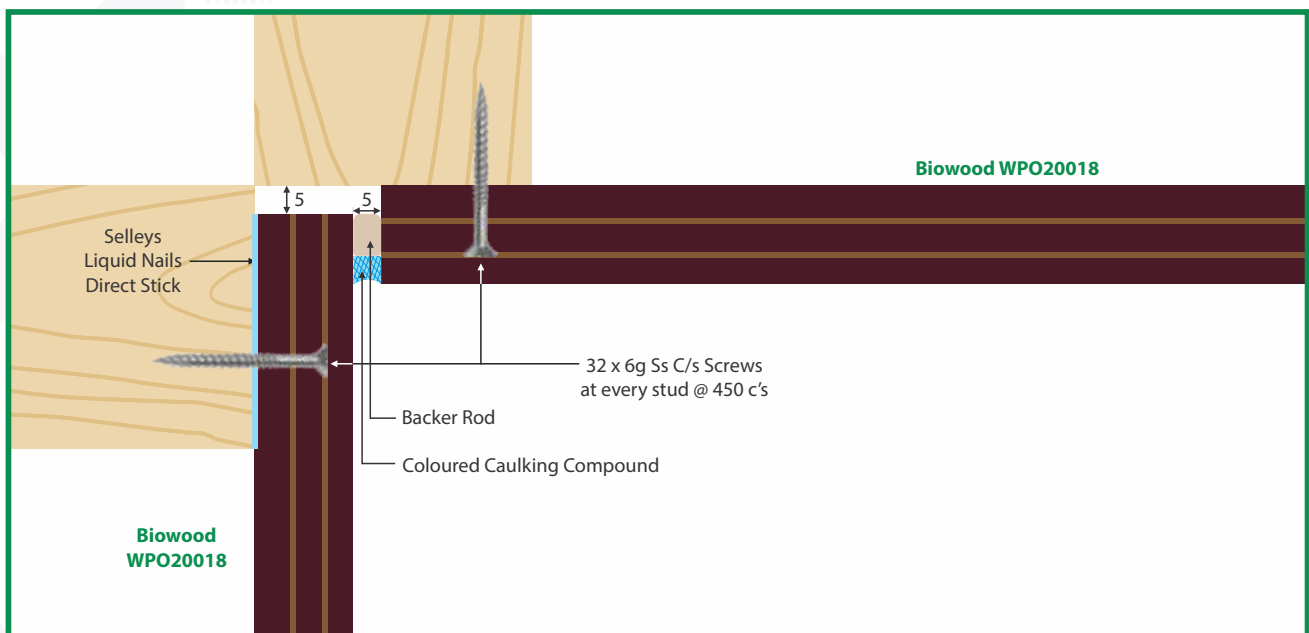

Soffit Lining

The installation of Biowood WPO20018 as a soffit lining is carried out in the same method as the wall installation.

End of profile detail

- Where the end or the long edge of Biowood WPO20018 will be visible, it can be capped off with a cut to width Biowood WPO6516
- See Diagram 6 / 20018 A, B & C.



INSTALLATION GUIDE

Biowood Outdoor Wall Panel BWPO20018 Shiplap 8x6 Deep

DIAGRAM 6 / 20018. Edge & end details

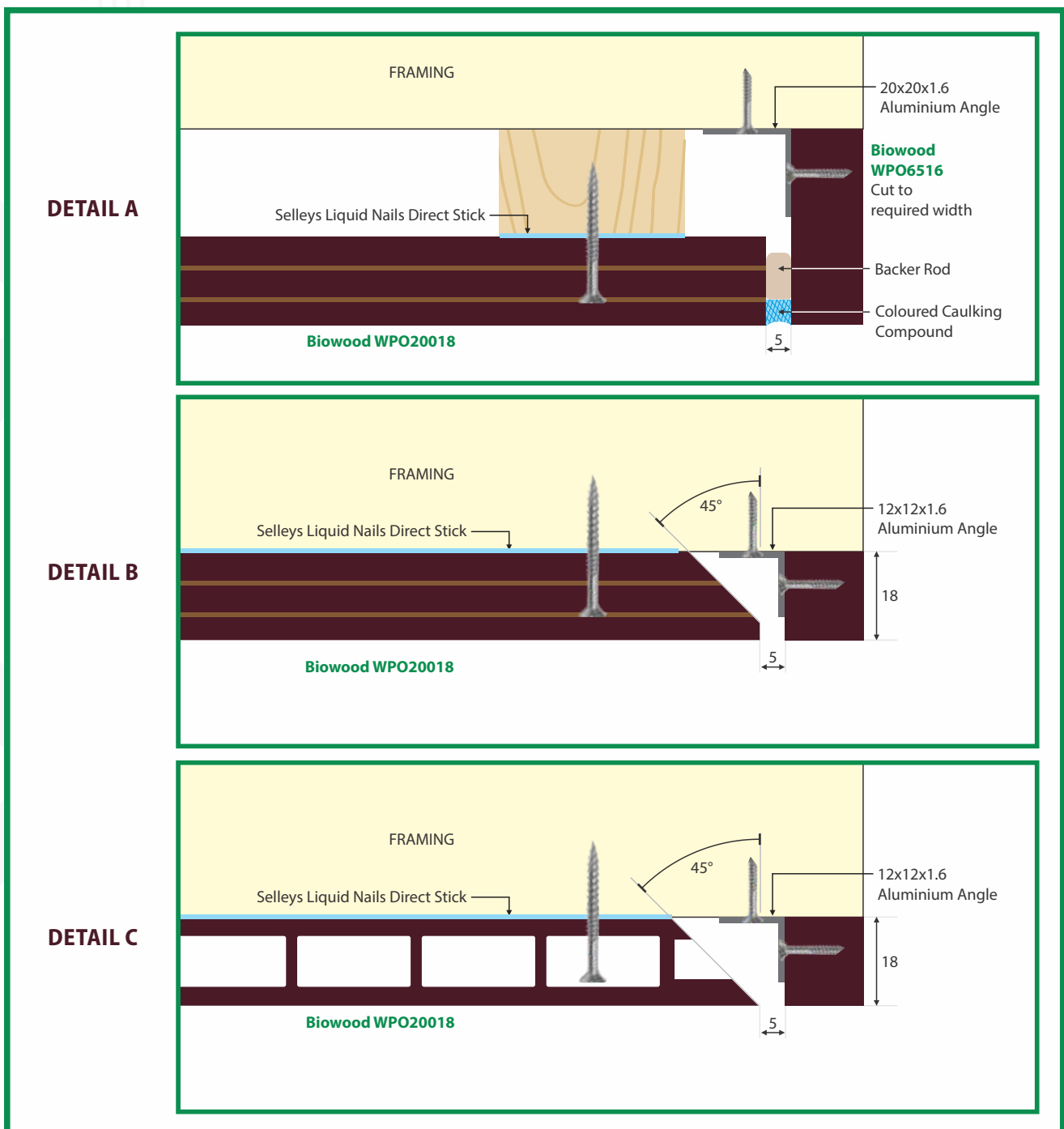



INSTALLATION GUIDE

Biowood Outdoor Wall Panel BWWPO20018 Shiplap 8x6 Deep

Butt joints and control joints

Biowood will expand and contract in length due to weather conditions. Although this movement will be minor, it is important to make allowances in your design to accommodate this movement.

At each end of every board an expansion gap must be allowed of widths varying from a minimum of 3mm to a maximum of 6mm. See below tables 1 and 2.

TABLE 1. Single Board Run Expansion Gaps

BOARD LENGTH	GAP AT EACH END
1000mm to 3000mm	3mm
3001mm to 4500mm	4mm
4501mm to 5850mm	5mm

TABLE 2. Expansion joint of multiple board run

MAXIMUM BOARD LENGTH	GAP AT BUTT JOINT
5850MM	6mm

DIAGRAM 7 / 20018. Cross Section: Typical Expansion Joint

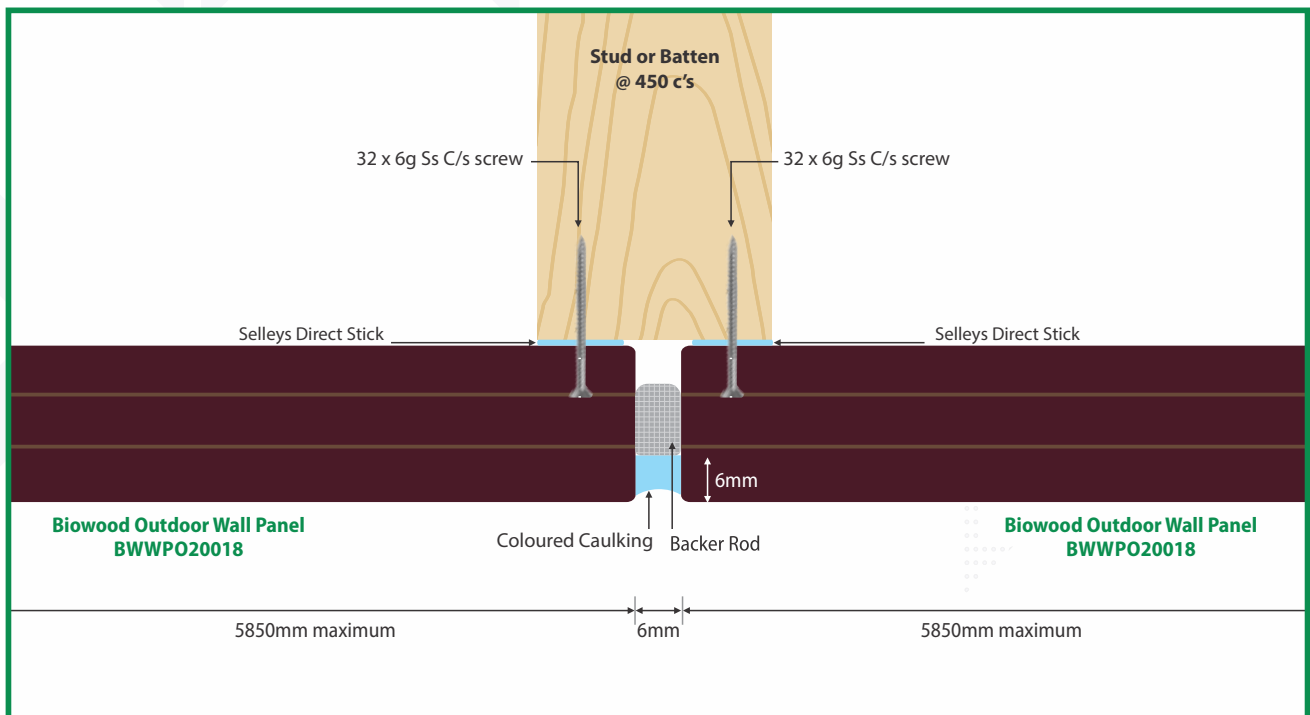



INSTALLATION GUIDE

Biowood Outdoor Wall Panel BWWPO20018 Shiplap 8x6 Deep

Coating of boards

When exposed to UV light, Biowood must be coated to control colour fading. Biowood products consist of 70% wood fiber and will turn grey if left unprotected.

In order to maintain the best appearance of your wall panels, Biowood must be coated with Intergrain Ultradeck in Natural for Spotted Gum, Red Cedar for Red Cedar and Grey for Weatherwood.

When two coats are applied in the correct thickness, recoating will not be required for 3 to 5 years depending on exposure. Apply coating in accordance with instructions on the can and printed literature.

Maintenance

Your Biowood outdoor wall panel will deliver many years of carefree maintenance. To maintain your pride in the beauty of this product it is recommended that the whole wall is washed down with clean tap water and lightly brushed with a soft hair brush or broom every three months. This action will remove dust, dirt, debris and atmospheric fall out which will accumulate on the shiplap shoulder where boards have been laid horizontal (see diagram G).

Vertically laid boards are naturally self cleaning. Wash every 6 months.

DIAGRAM 8 / 20018. Cross Section: Joint

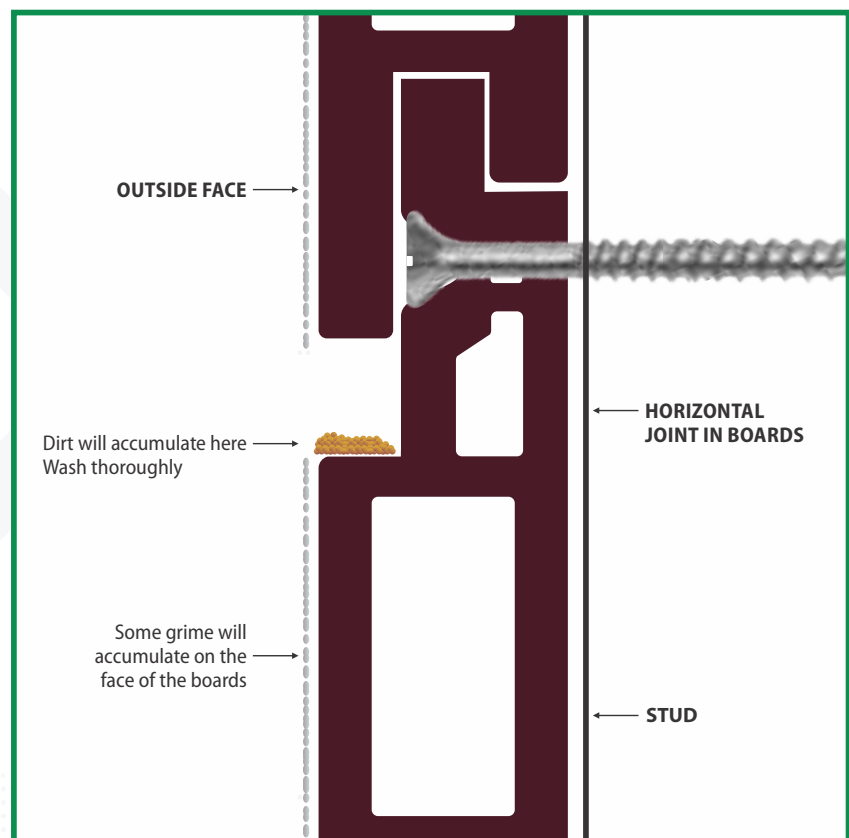

For further information, please contact Biowood Australia
P. +61 (2) 9644 6766
E. info@biowoodaustralia.com.au
biowoodaustralia.com.au